



2010 FRANKLIN COUNTY PROFILE



6314 6314

6314

3

NS
NORFOLK
SOUTHERN

EMU
15097

Location

Franklin County is located in the heart of south central Pennsylvania.

One of Franklin County's greatest assets is its proximity to substantial and growing industrial and consumer markets. Franklin County is situated within one day's drive of more than 50% of the U.S. population.

Franklin County still has room to grow! There are several industrial/business parks throughout the County encompassing over 1,000 acres of developable land, all of which are conveniently located to major transportation corridors and public utilities.

Portions of the Cumberland Valley Business Park are designated as a Keystone Opportunity Zone, offering abatement of all local real estate taxes and certain state taxes. Furthermore, portions of Franklin County are situated within Foreign Trade Zone 147 making it an ideal location to grow and expand businesses into international markets.

Transportation

The extensive interstate highways and rail networks traversing Franklin County provide immediate, easy, and safe access to major East Coast and Midwest markets.

HIGHWAYS

I-81 (north/south)

I-76 (east/west) PA Turnpike

I-70 (east/west)

US Route 30 (east/west)

US Route 11 (north/south)

RAIL

Norfolk Southern (mainline)

Norfolk Southern Rail/Freight Intermodal (planned opening 1st Quarter 2012)

CSX

CSX Rail/Freight Intermodal Terminal

Pennsylvania & Southern Rail (short line service within the Cumberland Valley Business Park)

AIR

Thurgood Marshall/BWI, Dulles International, and Reagan National...75 minutes

Harrisburg, PA International Airport...60 minutes

Hagerstown, MD Regional Airport (general aviation, limited commuter service)...10 minutes

MAJOR EMPLOYERS

Top Ten Employers in Franklin County

Letterkenny Army Depot	3,715
Summit Health	3,110
Chambersburg Area School District	1,400
Manitowoc Crane Group	1,200
Franklin County Government	950
Menno Haven, Inc.	600
Target Distribution Center	600
Food Lion, Inc.	550
Volvo Construction Equipment	520
Johnson Controls Frick Co.	500



Top Ten Manufacturing Employers in Franklin County

Manitowoc Crane Group	1,200
Volvo Construction Equipment	520
Johnson Controls Frick Co.	500
Martin's Famous Pastry Shoppe, Inc.	485
TB Woods, Inc.	440
Ventura Foods, LLC	380
Jerr-Dan Corporation	350
Valley Quarries, Inc.	260
Tyco Electronics	200
ISP Minerals, Inc.	170

Top Ten Transportation/Logistics Employers in Franklin County

Target Distribution Center	600
Food Lion, Inc.	550
World Kitchen, LLC	450
Ingram Book Company	440
National Book Network	325
K-Mart Specialty Center	300
Staples Direct	255
Cressler Trucking	225
Hoffman Transport	130
Ozburn Hessey Logistics	125

Employment is approximate
Prepared by the FCADC, January 2010

Franklin County

has a diversified workforce that is both highly skilled and dependable, and features an extremely strong work ethic.

Additionally, Franklin County's location is convenient to attracting workers from the neighboring Tri-state Region of Maryland, West Virginia, and Virginia.



Business Growth

ECONOMIC DEVELOPMENT INCENTIVES

In addition to our convenient location, ample development opportunities, superior workforce, and unparalleled quality-of-life, by choosing to locate in Franklin County, businesses can gain access to a myriad of incentive programs designed to support successful business growth. Some of the more widely used programs include:

Loan Programs

- **Small Business First Fund (SBFF):** Provides fixed rate, low-interest loan financing to small businesses (100 employees or less) for land and building acquisition, construction, machinery and equipment purchases or upgrades, and working capital. The maximum loan amount is \$200,000. **THE FCADC IS #1 IN THE STATE FOR USE OF THE SBFF PROGRAM!**
- **Pennsylvania Industrial Development Authority (PIDA):** Provides direct low-interest loans that assist with the purchase and/or construction of real estate. PIDA can typically finance up to 60% (or \$2,000,000, whichever is less) of a total project cost.
- **Franklin County First Fund (FCFF):** A low-interest loan program that is funded and administered by the FCADC and is targeted toward small businesses throughout Franklin County. Qualifying businesses must be for-profit and have 100 or fewer employees. An FCFF loan can finance up to 50% of a total project cost...not to exceed \$75,000. Interest rates are fixed for the term of the loan at 75% of current prime rate or 4%, whichever is greater.

- **Keystone Opportunity Zone:** Defined-parcel-specific areas with greatly reduced or no tax burden for property owners, residents, and businesses. KOZ's have been designated by local communities and approved by the state. The Cumberland Valley Business Park in Chambersburg has several KOZ designated areas available for industrial development.

Workforce Development

- **Guaranteed Free Training (WEDnetPA):** Qualified companies receive free job training, which is provided through the Workforce and Economic Development Network of Pennsylvania, known as WEDnetPA. Through the Guaranteed Free Training Program, businesses can access funding for a wide range of Basic Skills Training and Information Technology Training.

For a complete listing of potential economic development incentive programs, please visit www.newpa.com

Note: Certain programs are subject to funding availability, approval, and job creation requirements. All programs require an application process to be completed in order to access funds.

Tax Benefits

- **Job Creation Tax Credits:** Provides a \$1,000 tax credit to approved businesses that agree to create new jobs in the Commonwealth. A business must agree to create a minimum of 25 new jobs or new jobs equaling at least 20% of its existing workforce within three years.

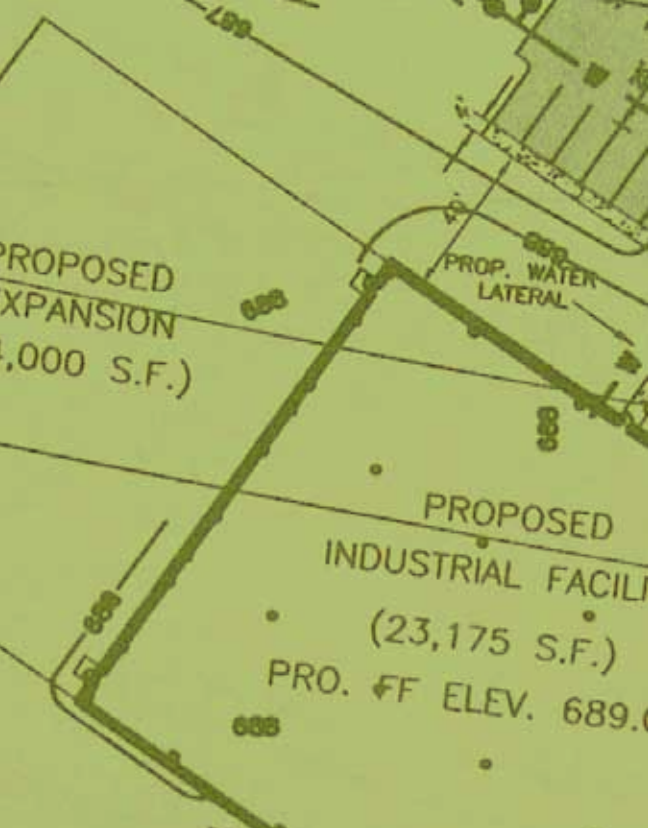

Taxes

The following is a summary of the most common Pennsylvania business taxes.

Personal Income Tax (PIT)

- Levied against the taxable income of resident, non-resident individuals, estates and trusts, partnerships, S corporations, and LLCs
- The current rate is 3.07% (note: retirement income is not subject to Pennsylvania income tax)

Corporate Net Income Tax (CNI)

- Levied on domestic and foreign corporations doing business, carrying on activities, having capital or property employed or used in Pennsylvania, or owning property in Pennsylvania
- Levied against federal taxable income without the federal net operating loss deduction
- The current rate is 9.99%

Real Estate Transfer Tax

- Imposed on the real value of property, including contracted improvements, transferred by deed, instrument, long term lease, or other writing
- The current rate is 2.0% (1% to State, 1% to County)

Capital Stock/Foreign Franchise Tax

- Levied on domestic corporations (incorporated in PA) and those foreign corporations (those incorporated outside PA)
- Foreign corporations pay tax on capital stock apportioned in PA
- The current millage rate is 2.89

Sales & Use (SUT) and Hotel Occupancy Tax

- Levied on the retail sale, consumption, rental, or use of tangible personal property (note: non ready-to-eat foods, certain wearing apparel, and residential heating fuels including, fuel oil, natural gas, coal, electricity, and firewood are exempt from tax)
- Collected and remitted by those engaged in making the taxable sale
- Hotel Occupancy Tax levied on room rental charges for periods of less than 30 days by the same person
- The current SUT and Hotel Occupancy Tax rate is 6.0%

Unemployment Compensation Tax (UC)

- Paid on the first \$8,000 of wages for each employee on an annual basis
- The current new employer rate (excluding construction) is 3.703%
- The current new employer rate for construction is 10.2626%
- The new employer rate is in effect for 2-3 years, at which time a new rate may be established based on the employers use of unemployment compensation

Workers' Compensation

- Mandatory coverage of employees engaged in the "regular course" of the employer's business
- Certain occupational classes are excluded



Source(s): Pennsylvania Department of Revenue and Pennsylvania Department of Labor and Industry

Other Taxes of Importance
(Not all taxes are universally levied. Depending on the locality there could be other taxes that are administered. For detailed taxes and rates see <http://munstatspa.dced.state.pa.us/MunicipalTaxInfo.aspx>)

- Real Estate Tax
 - Levied on the County, Municipal, and School District level
- Earned Income Tax
- Local Services Tax (LST)
- Per Capita Tax
- Amusement Tax

Source: Pennsylvania Department of Community and Economic Development Center for Local Government Services

Population

Since 2002, Franklin County reflected a vibrant growth rate of 9 percent. Over the past year, our County population has been the 2nd fastest growing in the entire state and 19th nationally for "micropolitan" areas.

2002	2004	2006	2008
131,225	134,185	139,683	143,495

Source: US Census Bureau, American Fact Finder, Population Estimates Program, 2008 Population Estimates. Chambersburg Public Opinion, *Census: Franklin County Growth Among the Fastest*, March 2009

POPULATION DEMOGRAPHICS

Male	70,083	49%
Female	73,412	51%
Median Age	39.8 years	

RACE

White	131,945	92.0%
Black/African American	5,443	3.8%
Hispanic/Latino	4,652	3.2%
Asian	819	0.6%
Two or more races	537	0.4%
American Indian & Alaskan Native	99	0.1%

Source: US Census Bureau, 2008 American Community Survey Demographic and Housing Estimates

Agriculture has been and continues to be a major component of Franklin County's economy.

Agriculture comprises more than 241,500 acres of land in Franklin County. In 2007, Franklin County ranked 4th in the state in total agricultural cash receipts. Additionally, statewide Franklin County ranked 2nd in the production of milk, cattle, apples, peaches, and corn for silage.

2007 CASH RECEIPTS

(in thousands)

Milk Production	\$183,940
Cattle & Calves	\$139,490
Hay (all types)	\$24,037
Corn for Silage	\$17,579
Corn for Grain	\$17,521
Eggs	\$16,436
Apples & Peaches	\$8,918
Barley	\$1,212

In order to sustain the current level of Agriculture well into the future, Franklin County has engaged in an aggressive agricultural land preservation program. To date, 115 farms have been preserved totaling more than 15,300 acres.

Source: Franklin County Agricultural Land Preservation Board & Penn State University Extension Service, November 2009

Retail,

FOOD SERVICES & ACCOMMODATIONS

Franklin County is home to several nationally known retail outlets, restaurants, and hotels/motels. In 2009, the leisure, hospitality, and retail trade sectors accounted for over 13,000 jobs.

MAJOR NATIONAL RETAILERS



MAJOR NATIONAL RESTAURANTS



MAJOR NATIONAL HOTELS/MOTEL FACILITIES



Source: Pennsylvania Department of Labor and Industry, Bureau of Workforce Information and Analysis, October Employment New Release, December 2, 2009

Quality of Life

EDUCATION

Franklin County provides a broad spectrum of educational opportunities ranging from pre-school through post-secondary.

The County is served by six public school districts, the Franklin County Career & Technology Center, three colleges/universities, and a satellite location of the Harrisburg Area Community College (HACC). Franklin County is also home to the prestigious Mercersburg Academy as well as other private institutions. Franklin County is within a two hour drive of Penn State University (University Park), one hour drive of the HACC main campus, and one-half hour drive from Gettysburg College and Dickinson College. In addition, the Hagerstown, MD Community College (HCC), Kaplan College of Hagerstown, MD, Mount St. Mary's University, and The University System of Maryland at Hagerstown are within a 15 minute drive of Franklin County.

School District	Enrollment
Chambersburg	8,883
Fannett-Metal	618
Greencastle-Antrim	3,165
Shippensburg	3,476
Tuscarora	2,814
Waynesboro	4,250

Source: Pennsylvania Department of Education, 2009-2010 Public School Enrollment Projections

COLLEGES AND UNIVERSITIES:



Shippensburg University
(rated Top 100 of America's Best Colleges 2010 (Tier 1 North) for Master's Degree Programs by US News and World Report)

PENNSTATE



Penn State University Mont Alto Campus (rated Top 50 America's Best National Colleges 2010 by US News and World Report)



Wilson College (rated Top 25 of America's Best Colleges 2010 (Tier 1 North) for Baccalaureate Colleges by US News and World Report)

Source: US News and World Report, America's Best College's 2010
<http://colleges.usnews.rankingsandreviews.com/best-colleges>

Public Utilities

Franklin County is served by a full range of public utilities to include electric, natural gas, telephone, broadband internet, cellular phone, solid waste disposal, water, and sewer. The costs of electric power and natural gas are consistently lower than state and national averages.



CRIME RATE

Franklin County boasts an extremely low crime rate across all categories of offenses. In 2008, the crime rate was 1.9% per 100,000 people.

Source: The Pennsylvania State Police, Uniform Crime Reporting System, Offenses Reported By County 2008

HOUSING

Franklin County offers a wide range of affordable housing opportunities.

- 2008 Median Value of owner occupied housing was estimated at \$185,300
- 60,559 total estimated housing units
- 3,469 total estimated vacant housing units

Source: US Census Bureau, American Fact Finder, American Community Survey, Selected Housing Characteristics 2008

INCOME

(2008 Inflation Adjusted Dollars)

- 2008 Median Household Income was estimated to be \$54,145
- 2008 Per Capita Personal Income was estimated to be \$25,944

Source: US Census Bureau, American Fact Finder, American Community Survey, Selected Economic Characteristics 2008

HEALTH CARE

Chambersburg Hospital

- 240 bed acute and critical care facility providing diagnostic, behavioral health, and surgical services with 24-hour emergency room service

Waynesboro Hospital (Ranked #1 Place to Work in Healthcare in the Nation 2008 by Modern Healthcare magazine)

- 64 bed full service diagnostic and therapeutic center, providing acute and critical care services, and surgical services with 24-hour emergency room

Franklin County is also served by two advanced life support companies. Expansions at both hospitals are expected in the near future. Chambersburg and Waynesboro Hospitals are supported by a broad network of Board Certified Physicians operating several outpatient and medical clinics.

- Chambersburg Hospital ranked "Top 5% in the Nation" by HealthGrades for coronary interventional procedures
- Waynesboro Hospital Emergency Department ranked in 99th percentile by Press Ganey for patient satisfaction
- Both hospitals are accredited by the Joint Commission on Accreditation of Health Care Organizations (JACHO)

In addition, Johns Hopkins Medical Center and the Penn State Milton S. Hershey Medical Center are within 75 miles.

Source: Summit Health, Annual Report 2009

Recreation

CULTURAL OPPORTUNITIES

Franklin County offers a wide variety of recreation and cultural opportunities, including:

Whitetail Resort (skiing/golf)

Penn National Golf Course (additional public and private golf courses in the area)

President James Buchanan Birthplace and Buchanan State Park

Michaux, Buchanan, and Tuscarora State Forests

Camp Penn State Park

Hunting and Fishing

Appalachian Trail

Capitol Theatre

Caledonia State Park and Totem Pole Playhouse

H. Ric Luhrs Performing Arts Center at Shippensburg University

Renfrew Institute for Cultural and Environmental Studies

Tayamentasachta Environmental Center

Extensive Network of Municipal Parks

In addition, Franklin County is within 30 minutes of historic Gettysburg and Antietam National Military Parks. Furthermore, Franklin County is within 15 minutes of Hagerstown, 30 minutes of Frederick, MD, 60 minutes of Harrisburg, PA and within 90 minutes of the Baltimore/Washington D.C. Metro areas thus creating significantly more opportunities for recreation, shopping, and cultural events.



IMPORTANT FRANKLIN COUNTY WEB LINKS

Greater Chambersburg Chamber of Commerce	www.chambersburg.org
Greater Waynesboro Chamber of Commerce	www.waynesboro.org
Greencastle-Antrim Chamber of Commerce	www.greencastlepachamber.org
Tuscarora Area Chamber of Commerce	www.mercersburg.org
Shippensburg Area Chamber of Commerce	www.shippensburg.org
County of Franklin (Government)	www.co.franklin.pa.us
Franklin County Visitor's Bureau	www.explorefranklincountypa.com
Franklin County CareerLink	www.cwds.state.pa.us
Shippensburg University Small Business Development Center	www.shipsbdc.org



The Franklin County Area Development Corporation is charged with formulating, implementing, and promoting a comprehensive county wide economic development strategy. The Corporation strives to create an atmosphere that nourishes planned growth and family sustainable employment opportunities.

1900 Wayne Road | Chambersburg, PA 17202 | (717) 263-8282 | (717) 263-0662 Fax

www.fcadc.com

Not responsible for any errors or omissions